

VILLAGE OF VERNON HILLS EXHIBIT NO. 28

BARRIER CURB

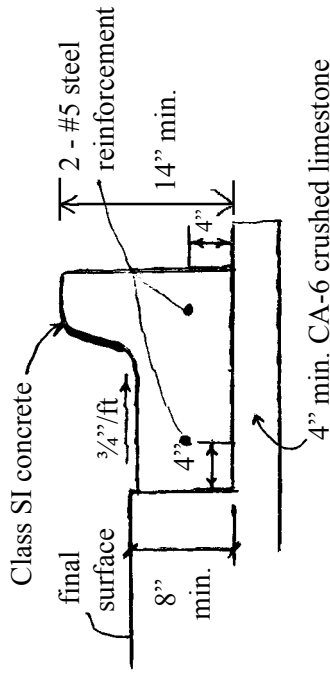

Notes:

1. Two (2) continuous #5 steel reinforcement bars are required for all public improvements, otherwise 2 - #5 steel reinforcement bars are required for all trench crossings, 10 feet either side of trench.
2. Control Joints shall be sawcut at 15 foot (max.) intervals, 1 1/2 inch deep, and within 24 hours.
3. Expansion joints shall be installed at all P.C.'s/P.T.'s, 5 foot either side of structures, 60 foot (max.) intervals with 3/4 inch preformed bituminous joint material and 2-3/4 inch smooth dowels w/caps. Fill all expansion joints with poured joint sealer in accordance with IDOT Specifications, Section 452 or current.
4. All curb and curb/gutter combination shall be placed on a minimum of 4 inches of compacted crushed limestone having the same specifications as the pavement subbase material.
5. Provide a method of curing per I.D.O.T. specifications. Protective coat required for all Village curb and gutter.
6. Carefully backfill curbs immediately after the 3-day cure.
7. All honeycombed curb is to be mortared upon removal of the forms.

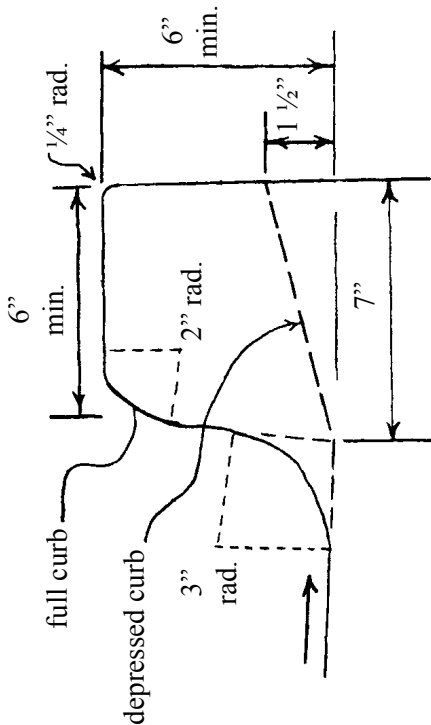

B-6xx CCC&G

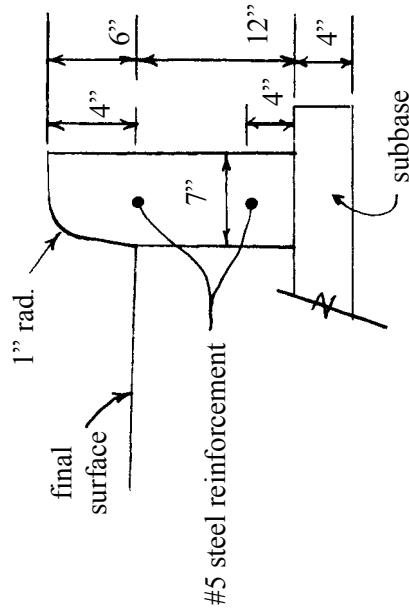

BARRIER CURB

*see dowel requirements adjacent to PCC pav't